

# Straight RTD (Resistance Temperature Detectors) with Terminal

R01

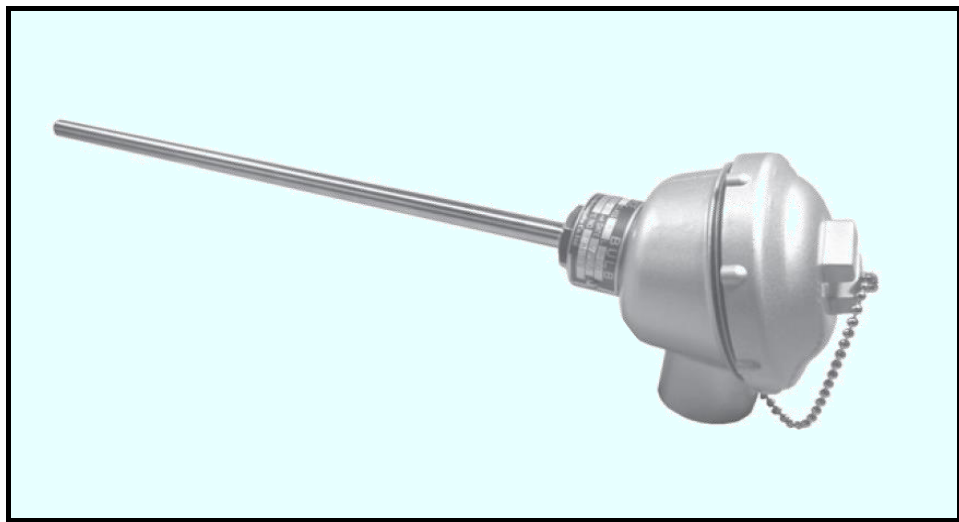

R01 is a resistance temperature detector with the simplest shape for a terminal box. By combining with loose flange (LFL) and compression fitting (CFG), it can be used for temperature measurement of ducts and tanks as an insertion type with adjustable insertion length.

## Features

- ★ With Connection head and terminal
- ★ Straight type with Protection tube
- ★ Please contact for special specifaicons

## Ordering code

R01 -         -     -    

Tolerance	Temp. range	Number of Element	Connection Head	Protection tube Diameter	Protection tube Material	Immersion Length	Special	Decsription	
A								Tolerance	Class A, Pt100Ω
B									Class B, Pt100Ω
	L							Temperature range	-60 to +180°C
	H								+180 to +600°C
		S						Number of Element	*Protection tube φ10 or more
		D							Single element
			N						Double element
			F					Connection Head	Standard : Die-cast aluminum (Weather proof)
			T						Special : Phenol resin
			W						2-way cable connection : Aluminum casting (Weather proof)
			K						Double cable connection : Aluminum casting (Weather proof)
									Small type : Die-cast aluminum (Weather proof)
				32				Protection tube Diameter	*Protection tube diameter φ12mm or less
				48					φ3.2mm
				64					φ4.8mm
				08					φ6.4mm
				10					φ8mm
				12					φ10mm
				15					φ12mm
				17					φ15mm
				22					φ17.3mm
					UB			Protection tube Material	φ21.7mm
					UC				304 SS (Stainless Steel) (0 to 1000°C)
					Z				316 SS (Stainless Steel) (0 to 1050°C)
								Immersion Length	Please inform us for other than above
						□□□			Immersion length below terminal box (mm)
							N	Special	Standard
							S		Special specification for example : 1) High accuracy Pt100Ω element 2) Pt100Ω element for Calorie calculation 3) Internal Signal converter (4 to 20mA output) for single element 4) etc.

\*Note 1 : Please contact us for special specifications or options.

\*Note 2 : The outer diameter of the protective tube that can be used with the small terminal box is φ12 or less.

\*Note 3 : If the outer diameter of the protective tube is φ3.2 to φ8, the protective tube is filled with magnesia (MgO) and the element cannot be replaced. If it is φ10 or more, it becomes a capsule element type and the element can be replaced.

## Common Specifications

Element	Pt100Ω resistance element
Wiring	3-wire
Tolerance	Class A : $\pm(0.15 + 0.002   t  )$ Class B : $\pm(0.3 + 0.005   t  )$
Measuring current	1mA
Number of element	Single / Double
Insulation resistance	100MΩ or more with 125V

## Dimensions

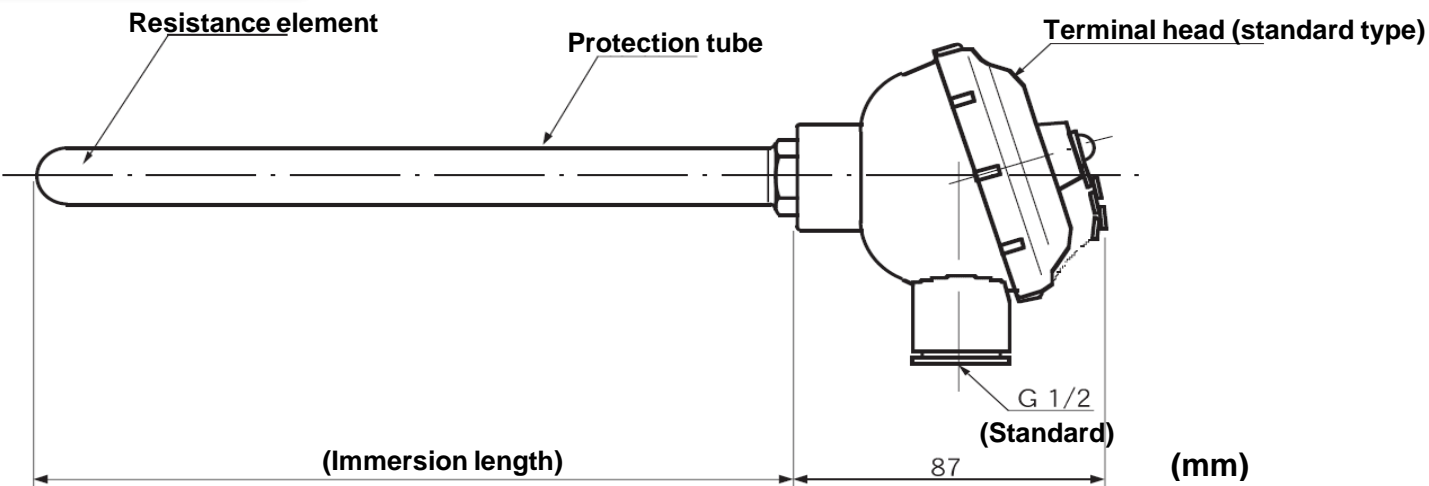

\* Specification is subject to change without notice